

PAGE[®]

INCORPORATED

Rework and Repair Systems

Desoldering Systems

Specialty Systems

Work Accessories

Materials, Tools and Aids

Training Services and Programs

PRICE BOOK

**EQUIPMENT, REPLACEMENT PARTS,
TRAINING PROGRAMS, AND SERVICES**

TERMS AND CONDITIONS OF SALE

Effective Date: March 1, 1989

1. Terms:

Export—Irrevocable Letter of Credit. Customer to Pay all Charges.
Domestic—Net 30 days on Rated Accounts.

2. Minimum Order:

Export—\$100.00 per destination.
Domestic—\$100.00 per destination.
Government—\$50.00 per destination.

3. Preservation, Packing, Packaging and Marking:

PACE Standard Commercial or Standard Export.

4. Shipping

F.O.B. Point—Laurel, Maryland, USA
All shipments will be insured unless otherwise specified.
Export shipments will be made via Air Freight—freight and insurance charges collect.

5. Prices

Prices and specifications are subject to change without notice.
Prices are Manufacturer's suggested list price.

ALL PRICES ARE IN ACCORDANCE WITH PACE'S TERMS AND CONDITIONS OF SALE.

TABLE OF CONTENTS

Page No.

Equipment, Quick-Reference Price Guide

3

Spare Parts, Quick-Reference Price Guide

4

Desoldering and Soldering Systems/Stations

5-11

| | | |
|---------|--|----|
| MBT-200 | MicroBenchTop™ Desoldering/Soldering System | 5 |
| MBT-100 | MicroBenchTop™ Desoldering System | 5 |
| MBT-10 | Desoldering/Soldering Station (Air-Operated) | 7 |
| MBT-5 | Desoldering Station (Air-Operated) | 7 |
| MP-1 | Micro™ Portable Desoldering System | 8 |
| MBT-210 | Digital Desoldering/Soldering System | 9 |
| SX-214A | PED-A-VAC™ Desoldering/Soldering Station | 11 |
| SX-213A | PED-A-VAC™ Desoldering Station | 11 |

Rework and Repair Systems

13-18

| | | |
|-----------|--|----|
| PRC-151 | Bench Top Repair System | 13 |
| PRC-351 | Bench Top Rework and Repair System | 15 |
| PRC-750A | Rework, Repair, and Manufacturing System | 17 |
| PRC-1000A | Rework, Repair, and Manufacturing System | 17 |

CRAFT®-25 System

19-20

CRAFT®-15 System

19-20

Specialty Systems

21-24

| | | |
|---------|---|----|
| PPF-40 | FuseSet™ System | 21 |
| PEP-220 | SwaPlating™ System (with power supply) | 23 |
| SMR-25 | Pulse-Heat SMD Reflow System | 24 |
| SMR-20 | Pulse-Heat SMD Reflow System, Economy Version | 24 |
| PPS-30 | Power Source | 24 |

Work Accessories

25-33

| | | |
|--------------------|--|----|
| Sodr-X-Tractors® | | 25 |
| TS-15 StripTweez® | Wire Stripper | 29 |
| TW-15 ResisTweez® | Resistance Heating | 29 |
| CT-15 ConducTweez® | Conductive Heating | 29 |
| LS-15 LapFlo® | Soldering | 30 |
| TP-15 ThermoPart® | Heating Probe | 30 |
| Soldering Irons | | 30 |
| HP-150 | Environmental Probe | 31 |
| VT-100 | Vacuum Cleaning and Handling Unit | 31 |
| SU-101 | Spray Unit | 31 |
| PE-210 | SwaPlating™/Gold Plating System (without power supply) | 32 |
| PM-181 | Minichine® | 33 |
| PM-166 | Minichine® | 33 |

Materials, Tools, and Aids

35-40

| | | |
|-----------------------|-------------------------|----|
| Cir-Kit® | Master Version | 35 |
| Cir-Kit® | Advanced Version | 35 |
| Cir-Kit® | Basic Version | 35 |
| Eyelets and Funnelets | | 37 |
| POL-15 | Optical Lighting System | 38 |
| POL-12 | Optical Lighting System | 38 |
| WP-6 | Work Handling Unit | 38 |
| T-450 | Special Aids Kit | 39 |
| T-400 | Tools Kit | 39 |
| Hand Tools | | 40 |

Training Services and Programs

41-46

| | |
|--|----|
| Basic Soldering Course, self-contained program | 41 |
| Rework and Repair Course, self-contained program | 42 |
| Multilayer Repair Course, self-contained program | 43 |
| Film Leasing Programs | 44 |
| Contract Training Services | 45 |
| Training Kits and Aids | 46 |

EQUIPMENT QUICK-REFERENCE PRICE GUIDE

Effective Date:
March 1, 1989

| Model Type and Description | | Part Number | Unit Price |
|--|---|-------------|------------|
| Desoldering and Soldering Systems | | | |
| MBT-210 | Digital Desoldering/Soldering System | 8007-0113 | \$ 875.00 |
| MBT-200 | Desoldering/Soldering System | 8007-0094 | 540.00 |
| MBT-100 | Desoldering System | 8007-0093 | 425.00 |
| MBT-10 | Desoldering/Soldering Station (Air-Operated) | 8007-0115 | 495.00 |
| MBT-5 | Desoldering Station (Air-Operated) | 8007-0108 | 395.00 |
| MP-1 | Portable Desoldering System | 8007-0087 | 450.00 |
| SX-214A | PED-A-VAC™ Desoldering/Soldering Station | 8007-0120 | 395.00 |
| SX-213A | PED-A-VAC™ Desoldering Station | 8007-0119 | 295.00 |
| Rework and Repair Systems | | | |
| PRC-151 | Bench Top Repair System | 8007-0118 | 1475.00 |
| PRC-351 | Bench Top Rework and Repair System | 8001-0042 | 3975.00 |
| PRC-750A | Rework, Repair, and Manufacturing System | 8001-0006 | 5550.00 |
| PRC-1000A | Rework, Repair, and Manufacturing System | 8001-0007 | 6250.00 |
| Specialty Systems | | | |
| FFP-40 | FuseSet™ System (with integral power supply) | 8004-0001 | 1275.00 |
| PEP-220 | SwaPlating™ System (includes power supply) | 7003-0003 | 650.00 |
| SMR-25 | Pulse-Heat SMD Reflow System | 8042-0003 | 695.00 |
| SMR-20 | Pulse-Heat SMD Reflow System, Economy Version | 8042-0001 | 495.00 |
| PPS-30 | Power Source | 7008-0172 | 325.00 |
| Work Accessories | | | |
| SX-25 | Dual-Path Sodr-X-Tractor® | 7010-0025 | 99.00 |
| SX-25V | Dual-Path Sodr-X-Tractor® (finger-valve) | 7010-0026 | 99.00 |
| SX-55 | MBT Sodr-X-Tractor® | 6010-0054 | 138.00 |
| PM-181 | Minichine® (Blade Type) | 7005-0010 | 145.00 |
| PM-166 | Minichine® (Tang Type) | 7005-0011 | 145.00 |
| TS-15 | StripTweez® Wire Stripper | 7012-0002 | 99.00 |
| TW-15 | ResisTweez® Resistance Heating | 7009-0005 | 98.00 |
| CT-15 | ConducTweez® Conductive Heating | 7020-0001 | 110.00 |
| LS-15 | LapFlo® Soldering | 7022-0003 | 86.00 |
| TP-15 | ThermoPart® Heating Probe | 7013-0004 | 84.00 |
| HP-150 | Environmental Probe | 7002-0001 | 125.00 |
| VT-100 | Vacuum Cleaning & Handling Unit | 7014-0001 | 48.00 |
| SU-101 | Spray Unit | 7011-0001 | 135.00 |
| PE-210 | SwaPlating™/Gold Plating Kit | 7003-0002 | 425.00 |
| Materials, Tools, and Aids | | | |
| CIR-KIT® | Master Version | 6993-0082 | 149.00 |
| CIR-KIT® | Advanced Version | 6993-0077 | 79.00 |
| CIR-KIT® | Basic Version | 6993-0037 | 45.00 |
| WP-6 | Work Handling Unit | 7015-0009 | 250.00 |
| POL-15 | Optical Lighting System | 7007-0004 | 325.00 |
| POL-12 | Optical Lighting System | 7007-0006 | 300.00 |

ALL PRICES ARE IN ACCORDANCE WITH PACE'S TERMS AND CONDITIONS OF SALE.

SPARE PARTS QUICK-REFERENCE GUIDE

SX-25 AND SX-20 SODR-X-TRACTOR® PARTS AND TIPS

Effective Date: March 1, 1989

| Item Description | Part Number | Unit Price |
|--|---------------|----------------|
| Super Tips | | |
| .020 ID | 1121-0213 | \$18.75 pk./25 |
| .030 ID | 1121-0214 | 18.75 pk./25 |
| .040 ID | 1121-0215 | 18.75 pk./25 |
| .050 ID | 1121-0216 | 18.75 pk./25 |
| .061 ID | 1121-0217 | 18.75 pk./25 |
| .095 ID | 1121-0091 | 18.75 pk./25 |
| Handpiece Assembly Parts | | |
| Glass Chamber | 1265-0009-P1 | 4.50 |
| "S" Baffle | 4010-0033 | 1.15 |
| Sodr-X-Tractor® Filters | | |
| Package of 10 | 1309-0018-P10 | 2.25 pk./10 |
| Package of 50 | 1309-0018-P50 | 10.60 pk./50 |
| Heater and Seal Assembly, 35W Dual Path® | 6010-0034-P1 | 32.00 |
| Set Screw | 1348-0285-P10 | 6.85 pk./10 |
| Line Cord Assembly | 1332-0009-P1 | 18.75 |
| Baffle and End Cap Assembly | 4010-0071 | 11.95 |
| Wire Brush | 1127-0006-P5 | 9.75 pk./5 |
| Bristle Brush | 1127-0002-P5 | 9.00 pk./5 |
| Front Seal | 1213-0033 | 3.50 |
| Rear Seal | 1213-0001 | 3.75 |

SX-55 AND SX-40 SODR-X-TRACTOR® PARTS AND TIPS

| Item Description | Part Number | Unit Price |
|---|-----------------|---------------|
| Micro Tips | | |
| .025 ID | 1121-0253 | \$ 7.50 pk./5 |
| .036 ID | 1121-0254 | 7.50 pk./5 |
| .061 ID | 1121-0255 | 7.50 pk./5 |
| Handpiece Assembly Parts | | |
| Glass Chamber | 1265-0009-P1 | 4.50 |
| "S" Baffle | 4010-0033 | 1.15 |
| Sodr-X-Tractor® Filters | | |
| Package of 10 | 1309-0018-P10 | 2.25 pk./10 |
| Package of 50 | 1309-0018-P50 | 10.60 pk./50 |
| SX-55 Heater and Seal Assembly, 24 VAC | 6010-0055-P1 | 38.00 |
| SX-40 Heater and Seal Assembly, 12 VDC | 6010-0038-P1 | 38.00 |
| Set Screws | 1348-0287-P10 | 6.85 pk./10 |
| Baffle and End Cap Assembly (SX-55) | 4010-0082 | 11.95 |
| Baffle and End Cap Assembly (SX-40) | 4010-0071 | 11.95 |
| Wire Brush | 1127-0006-02-P5 | 15.00 pk./5 |
| Bristle Brush | 1127-0002-P5 | 9.00 pk./5 |
| Tip Tool | 1100-0206 | 2.50 |
| Heat Dissipator | 1360-0005 | 5.35 |
| VisiFilter® Assemblies and Filter Elements | | |
| Fixed VisiFilter® | 1309-0020 | 5.95 |
| Replaceable VisiFilter® | 1309-0028 | 8.95 |
| Replaceable VisiFilter® Elements | | |
| Package of 10 | 1309-0027-P10 | 7.25 pk./10 |
| Package of 25 | 1309-0027-P25 | 15.50 pk./25 |
| Package of 50 | 1309-0027-P50 | 25.60 pk./50 |
| Soldering Iron Tips | | |
| 1/8" Chisel Tip | 1121-0130-P5 | 21.95 pk./5 |
| 1/16" Chisel Tip | 1121-0131-P5 | 21.95 pk./5 |
| Needle Tip | 1121-0132-P5 | 21.95 pk./5 |

ALL PRICES ARE IN ACCORDANCE WITH PACE'S TERMS AND CONDITIONS OF SALE.

MBT-200/ MBT-100

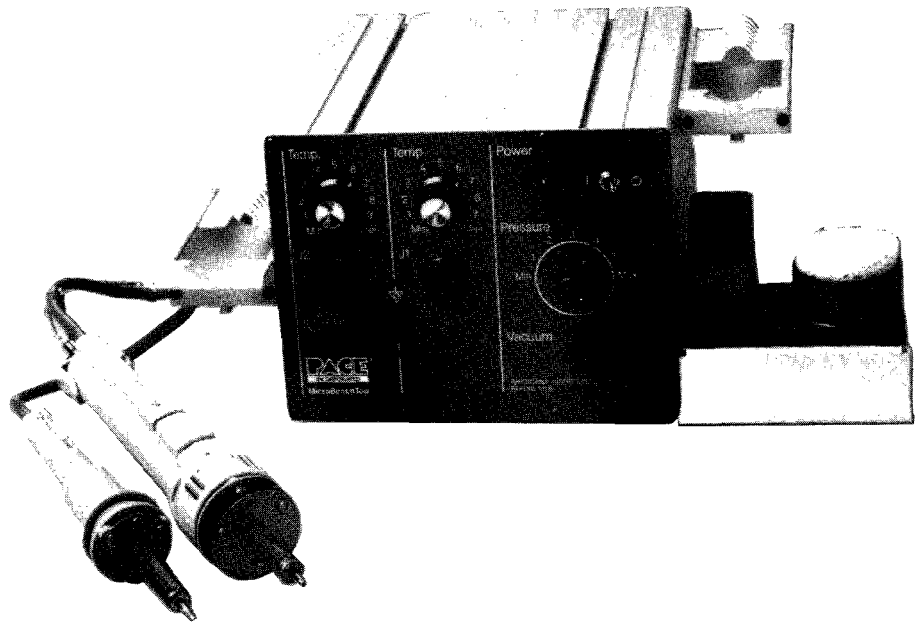

| Model Number & Description | Part Number | Unit Price | Replacement Parts |
|---|-------------|-----------------------|-------------------|
| MBT-200 Desoldering and Soldering System, Complete | 8007-0094 | \$540.00 | |
| <i>Consisting of:</i> | | | |
| MBT-200 Power Source | 7008-0154 | (not sold separately) | See Pg. 6 |
| SX-55 Sodr-X-Tractor® | 6010-0054 | | See Pg. 27 |
| Micro™ Soldering Iron | 6025-0004 | | See Pg. 30 |
| Hot Cubby | 6019-0019 | | See Pg. 6 |
| Cleaning Station | 6021-0004 | | See Pg. 6 |
| MBT-100 Desoldering System, Complete | 8007-0093 | 425.00 | |
| <i>Consisting of:</i> | | | |
| MBT-100 Power Source | 7008-0153 | (not sold separately) | See Pg. 6 |
| SX-55 Sodr-X-Tractor® | 6010-0054 | | See Pg. 27 |
| Hot Cubby | 6019-0019 | | See Pg. 6 |

OPTIONAL ITEMS FOR MBT-200 AND MBT-100

| Item Description | Part Number | Unit Price | Replacement Parts |
|---|-------------|------------|-------------------|
| Cir-Kit® Master Version | 6993-0082 | \$149.00 | See Pg. 35 |
| Cir-Kit® Advanced Version | 6993-0077 | 79.00 | See Pg. 35 |
| Cir-Kit® Basic Version | 6993-0037 | 45.00 | See Pg. 35 |
| POL-15 Optical Lighting System | 7007-0004 | 325.00 | See Pg. 38 |
| WP-6 Work Handling Unit | 7015-0009 | 250.00 | See Pg. 38 |
| POL-12 Optical Lighting Fixture | 7007-0006 | 300.00 | See Pg. 38 |
| Soldering Handbook | 5050-0082 | 6.50 | |
| Rework and Repair Handbook | 6031-2100 | 15.75 | |
| Carrying Handle for MBT, with fasteners | 6993-0094 | 7.95 | |

ALL PRICES ARE IN ACCORDANCE WITH PACE'S TERMS AND CONDITIONS OF SALE.

MBT-200/100

SPARE PARTS

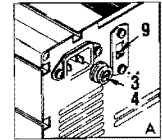
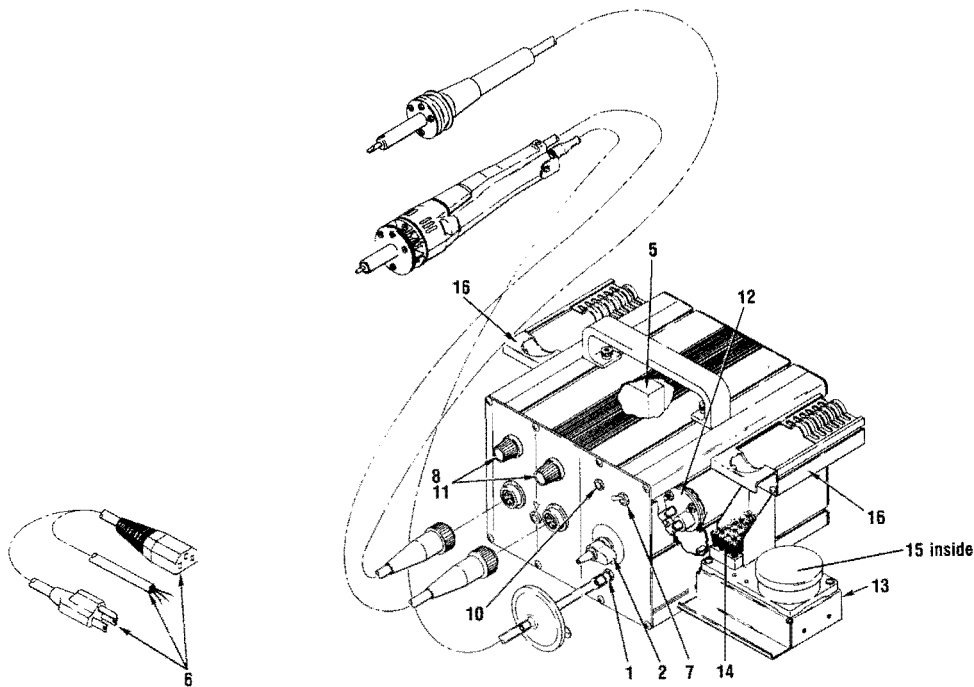

| Item Number | Item Description | Part Number | Unit Price |
|-------------|--|--------------|-------------|
| 1 | Vacuum Valve Stem | 1263-0021 | \$ 1.95 |
| 2 | Air Flow Control Valve Assembly | 1285-0033 | 12.00 |
| 3 | Fuseholder | 1161-0008 | 3.95 |
| 4 | Fuse, 1.6 AMP, SloBlo | 1159-0235-P5 | 6.50 pk./5 |
| 5 | Transformer | 1192-0050 | 58.00 |
| 6 | Line Cord | 1332-0094 | 8.95 |
| 7 | Switch, ON-OFF Power (MBT-200 and MBT-100) | 1157-0040 | 7.50 |
| 8 | AC Var. Voltage Control | 1179-0133 | 4.75 |
| 9 | Voltage Selector Switch, Rear Panel | 1157-0041 | 9.75 |
| 10 | LED | 1183-0026 | 6.25 |
| 11 | Knob | 1222-0006 | 2.75 |
| 12 | Motor Pump Assembly | 6008-0101 | 150.00 |
| (not shown) | Carbon Vanes | 1800-0003-P4 | 12.00 pk./4 |
| (not shown) | Fan | 1500-0003 | 1.50 |
| (not shown) | Wear Plate, Port | 1338-0044 | 3.95 |
| (not shown) | Wear Plate, Motor | 1338-0045 | 3.95 |
| 13 | Cleaning Station Assembly (MBT-100/200/10/5) | 6021-0004 | 18.95 |
| 14 | Wire Brush | 1127-0012 | 4.95 |
| 15 | Sponge | 4021-0001-P5 | 6.25 pk./5 |
| (not shown) | Hardware Mounting Kit | 6993-0086 | 9.95 |
| 16 | Hot Cubby (right side) | 6019-0019-01 | 17.50 |
| 16 | Hot Cubby (left side) | 6019-0019-02 | 17.50 |
| (not shown) | Accessory Kit (MBT-200) | 7900-0003 | 29.95 |
| (not shown) | Accessory Kit (MBT-100) | 7900-0002 | 19.95 |

ALL PRICES ARE IN ACCORDANCE WITH PACE'S TERMS AND CONDITIONS OF SALE.

MBT-10/ MBT-5



| Model Number & Description | Part Number | Unit Price | Replacement Parts |
|--|-------------|-----------------------|-------------------|
| MBT-10 Desoldering and Soldering Station (Air-Operated), Complete | 8007-0115 | \$495.00 | |
| <i>Consisting of:</i> | | | |
| MBT-10 Power Source | | (not sold separately) | See Pg. 6 |
| SX-55 Sodr-X-Tractor® | 6010-0054 | | See Pg. 27 |
| Micro™ Soldering Iron | 6025-0004 | | See Pg. 30 |
| Hot Cubby | 6019-0019 | | See Pg. 6 |
| Cleaning Station | 6021-0004 | | See Pg. 6 |
| MBT-5 Desoldering Station (Air-Operated), Complete | 8007-0108 | 395.00 | |
| <i>Consisting of:</i> | | | |
| MBT-5 Power Source | | (not sold separately) | See Pg. 6 |
| SX-55 Sodr-X-Tractor® | 6010-0054 | | See Pg. 27 |
| Hot Cubby | 6019-0019 | | See Pg. 6 |

OPTIONAL ITEMS FOR MBT-10 AND MBT-5

| Item Description | Part Number | Unit Price | Replacement Parts |
|--------------------------------|-------------|------------|-------------------|
| Cir-Kit® Master Version | 6993-0082 | \$149.00 | See Pg. 35 |
| Cir-Kit® Advanced Version | 6993-0077 | 79.00 | See Pg. 35 |
| Cir-Kit® Basic Version | 6993-0037 | 45.00 | See Pg. 35 |
| POL-15 Optical Lighting System | 7007-0004 | 325.00 | See Pg. 38 |
| WP-6 Work Handling Unit | 7015-0009 | 250.00 | See Pg. 38 |
| Soldering Handbook | 5050-0082 | 6.50 | |
| Rework and Repair Handbook | 6031-2100 | 15.75 | |

ALL PRICES ARE IN ACCORDANCE WITH PACE'S TERMS AND CONDITIONS OF SALE.